

## Technical Specifications

<b>NAND Components</b>	2Xnm Multi-Level Cell (Sync MLC)
<b>Interface</b>	SATA III / 6Gbps (Backwards compatible with SATA II / 3Gbps, but optimized for SATA 6Gbps)
<b>Form Factor</b>	2.5 Inch
<b>Controller</b>	SandForce® 2281
<b>Dimensions (L x W x H)</b>	100.0 x 70.0 x 9.4 mm
<b>Weight</b>	79g
<b>Shock Resistance</b>	1500G
<b>Certifications</b>	RoHS, CE, FCC
<b>MTBF</b>	2 million hours
<b>Power Consumption Idle</b>	1.5 Watts Active: 2.7 Watts
<b>Temperature Operating</b>	0°C ~ 70°C Ambient: 0°C ~ 55°C Storage: -45°C ~ 85°C
<b>ECC Recovery</b>	Up to 55 bits correctable per 512-byte sector (BCH) *varies depending on exact configuration
<b>Product Health Monitoring</b>	Self-Monitoring, Analysis and Reporting Technology (S.M.A.R.T.)
<b>Serial ATA (SATA)</b>	Fully compliant with Serial ATA International Organization: Serial ATA Revision 3.0. Fully compliant with ATA/ATAPI-8 Standard Native Command Queuing (NCQ)
<b>Operating System</b>	Windows XP 32-Bit and 64-Bit; Windows Vista 32-Bit and 64-Bit; Windows 7 32-Bit and 64-Bit; Mac OS X; Linux
<b>Power Requirements</b>	Standard SATA Power Connector
<b>Performance Optimization</b>	TRIM (requires OS support)
<b>Service &amp; Support</b>	3-Year Warranty, Free Tech Support, Firmware Update

## Mechanical Drawing ML-X8 Series SSD

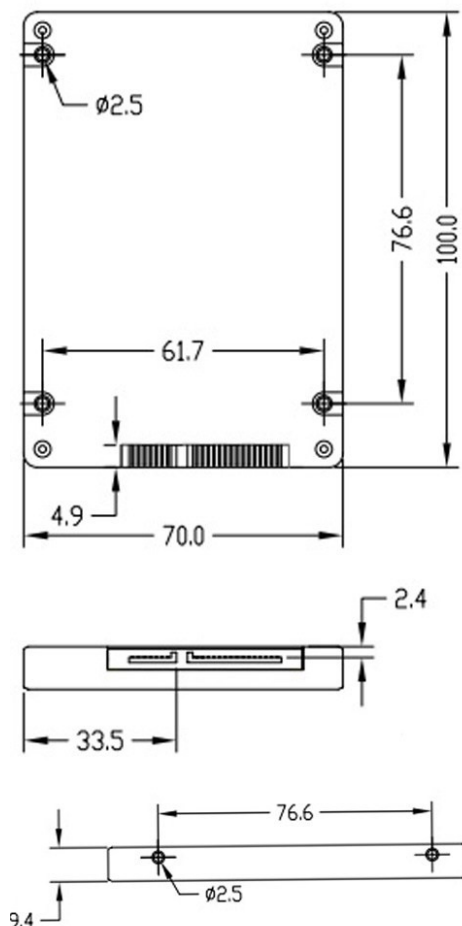

## Winkom ML-X8 SSD Specifications

### Product View / Part Numbers

60GB	WMX8-25SA3-60G
120GB	WMX8-25SA3-120G
240GB	WMX8-25SA3-240G
480GB	WMX8-25SA3-480G

#### ML-X8 Key features

- \* SATA 6Gb/s
- \* 550 MB/s sequential read
- \* 525 MB/s sequential write
- \* 85k Random IOPS (4k aligned)
- \* Synchronous NAND

